

User Manual

FMJ-Group

Models:
FMJ-V15Pro, FMJ-V12Pro

REV. 27/02/26



福美净
FUMEIJING GROUP

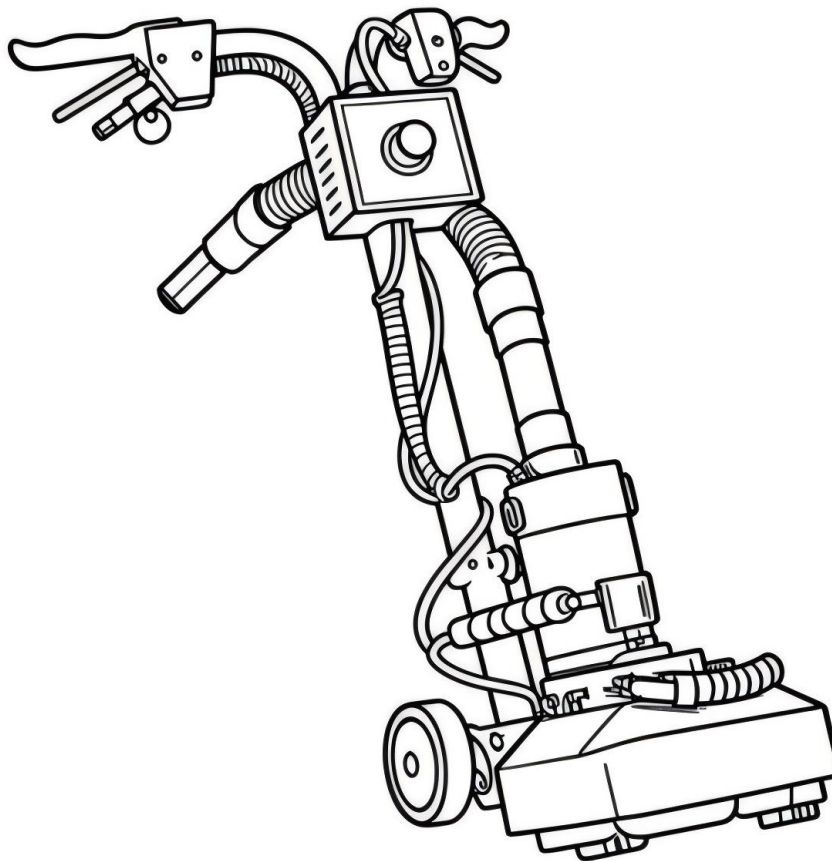

Caizhuang Town ,WeiShi County,KaiFeng City
,HeNan Province China 475000
P: (86) 18537382691
www.fumeijinggroup.com

	Important Safety Information.....	4
1	At a Glance	6
	1.1 - Technical Specifications.....	6
	1.2 - Included with the FMJ-V15Pro	6
	1.3 - FMJ-V15Pro Front View	7
2	Machine Operation	8
	2.1 - Powering the FMJ-V15Pro	8
	2.2 - Installing the Cleaning Head	8
	2.3 - Connecting the Hoses	8
	2.4 - Lowering the Handle	8
	2.5 - Switching On the FMJ-V15pro	8
	2.6 - Cleaning With the FMJ-V15pro	9
	2.7 - After Cleaning	9
3	Machine Maintenance	10
	3.1 - Lubricating the Felt Vacuum Seal	10
4	Troubleshooting	11

Important Safety Information

Please read and understand this manual completely before operating this machine.

Grounding Instructions

This machine must be grounded. If it should malfunction or break down, grounding provides a path of least resistance for electrical shock. This machine is equipped with a cord having an equipment-grounding conductor and grounding plug. The plug must be plugged into an appropriate outlet that is properly installed in accordance with all local code and ordinances. Do not remove ground pin; if missing, replace plug before use.



DANGER

Improper installation of the equipment-grounding conductor can result in a risk of electric shock. Be sure to check with a qualified electrician or service person if you are in doubt as to whether the outlet is properly grounded. If the plug will not fit in the outlet do not modify the plug or the machine's cord, instead have a proper outlet installed by a qualified technician.

This machine is for use on a nominal 120-volt circuit and with a grounding plug similar to the one in Figure 1 below. If a proper outlet is not available, follow the illustrations of Figure 2 & 3 to install a temporary-grounding plug. This temporary work-around should be used only until a proper outlet (Figure 1) can be installed by a qualified electrician. When and if this type of adapter is employed, screw the adapter's extended tab into place with a metal screw. However, grounding adapters are not approved for use in Canada.

Again, be sure to check the grounding pin for damages and replace if necessary.

The Green, or Green-Yellow, wire in the cord is the grounding wire. When replacing a plug, this wire must be attached to only the grounding pin.

DO NOT use extension cords.

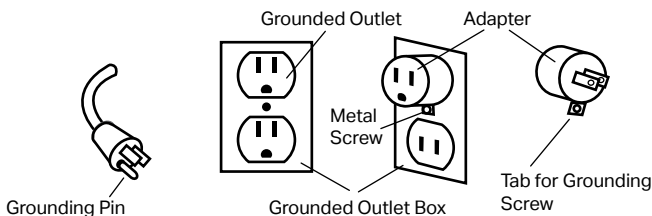

Figure 1

Figure 2

Figure 3

Please Note for America use only.

Parts and Service

Please contact FMJ-Group service personnel or a FMJ-Group thorized Service Center using FMJ-Group original replacement parts and accessories if repairs need to be performed. When and if calling FMJ-Group for support, please have your Model and Serial Number available for faster assistance.

Name Plate

The Model are located on the back of the motor and will be required for ordering replacement parts. You can use the space provided in this manual to note down both for future referencing.

Unpacking the Machine

When your new machine is delivered, please carefully inspect both the shipping carton and the machine for damages. If damage is evident, save both the shipping carton and machine so that the delivering carrier can inspect it. Contact the carrier immediately to file a freight claim if there has been any damage.

Caution and Warnings

Symbols

FMJ-Group uses the symbols below to signal potentially dangerous conditions. Always read this information carefully and take the necessary steps to protect personnel and property.



DANGER

Is used to warn of immediate hazards that will cause severe personal injury or death.



WARNING

Is used to call attention to a situation that could cause severe personal injury.



CAUTION

Is used to call attention to a situation that could cause minor personal injury or damage to the machine or other property. When using an electrical appliance, basic precautions should always be followed, including the following: Read all instructions before using this machine. This product is intended for commercial use only.

To reduce the risk of fire, electrical shock, or injury:

1. Read all instructions before using equipment.
2. Use only as described in this manual. Use only manufacturer's recommended attachments.

Important Safety Information

- 3.** Always unplug power cord from electrical outlet before attempting any adjustments or repairs.
- 4.** Do not unplug by pulling on cord. To unplug, grasp the plug, not the cord.
- 5.** Do not pull or carry by cord. Do not close a door on cord or pull cord around sharp edges or corners.
- 6.** Do not run appliance over cord. Keep cord away from heated surfaces.
- 7.** Do not use with damaged cord or plug. If cord is damaged, repair immediately.
- 8.** Do not use outdoors or on wet surfaces and/or standing water.
- 9.** Always unplug or disconnect the appliance from power supply when not in use.
- 10.** Do not allow to be used as a toy. Close attention is necessary when used by or near children.
- 11.** Do not use in areas where flammable or combustible material may be present.
- 12.** Do not leave the unit exposed to harsh weather elements. Temperatures below freezing may damage components and void warranty.
- 13.** Use only the appropriate handles to move and lift unit. Do not use any other parts of this machine for this purpose.
- 14.** Keep hair, loose clothing, fingers, and all parts of the body away from all openings and moving parts.
- 15.** Use extra care when using on stairs.
- 16.** To reduce the risk of fire or electric shock, do not use this machine with a solid-state speed control device.
- 17.** The voltage and frequency indicated on the name plate must correspond to the wall receptacle supply voltage.
- 18.** When cleaning and servicing the machine, local or national regulations may apply to the safe disposal of liquids which may contain: chemicals, grease, oil, acid, alkalines, or other dangerous liquids.
- 19.** Do not leave operating unattended.

1 - At a Glance

1.1 - Technical Specifications

FMJ-15Pro

Cleaning Path	15"
Jets	3x 11003
Vacuum	3x vacuum slots
Speed	Adjustable 0-280 RPM
Motor	0.6 horsepower
Power Cord	Single 32' 16/3 extension cord
Amp Draw	4.5 amps @ 120V 60Hz 5.5amps @ 230V 50Hz
Product Weight	60 lbs.
Product Dimensions	22" x 16.9" x 18"

FMJ-12Pro

Cleaning Path	12"
Jets	3x 111003
Vacuum	3x vacuum slots
Speed	Adjustable 0-280 RPM
Motor	0.6 horsepower
Power Cord	Single 32' 16/3 extension cord
Amp Draw	4.5 amps @ 120V 60Hz 5.5 amps @ 230V 50Hz
Product Weight	55 lbs.
Product Dimensions	22" x 16.9" x 18"

1.2 - Included with the FMJ-15 pro

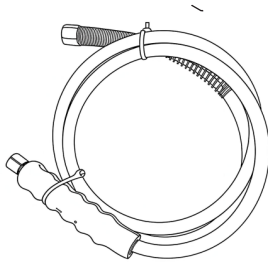

Steam Hose

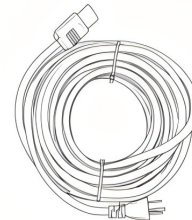

32' Extension Cord

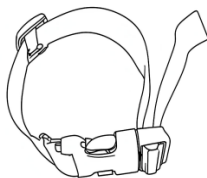

Buckle Strap

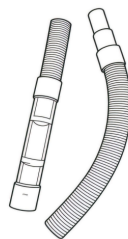

Vacuum Hose

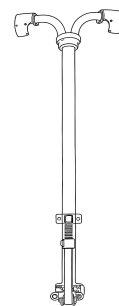

Handle

FMJ-V15Pro Front View

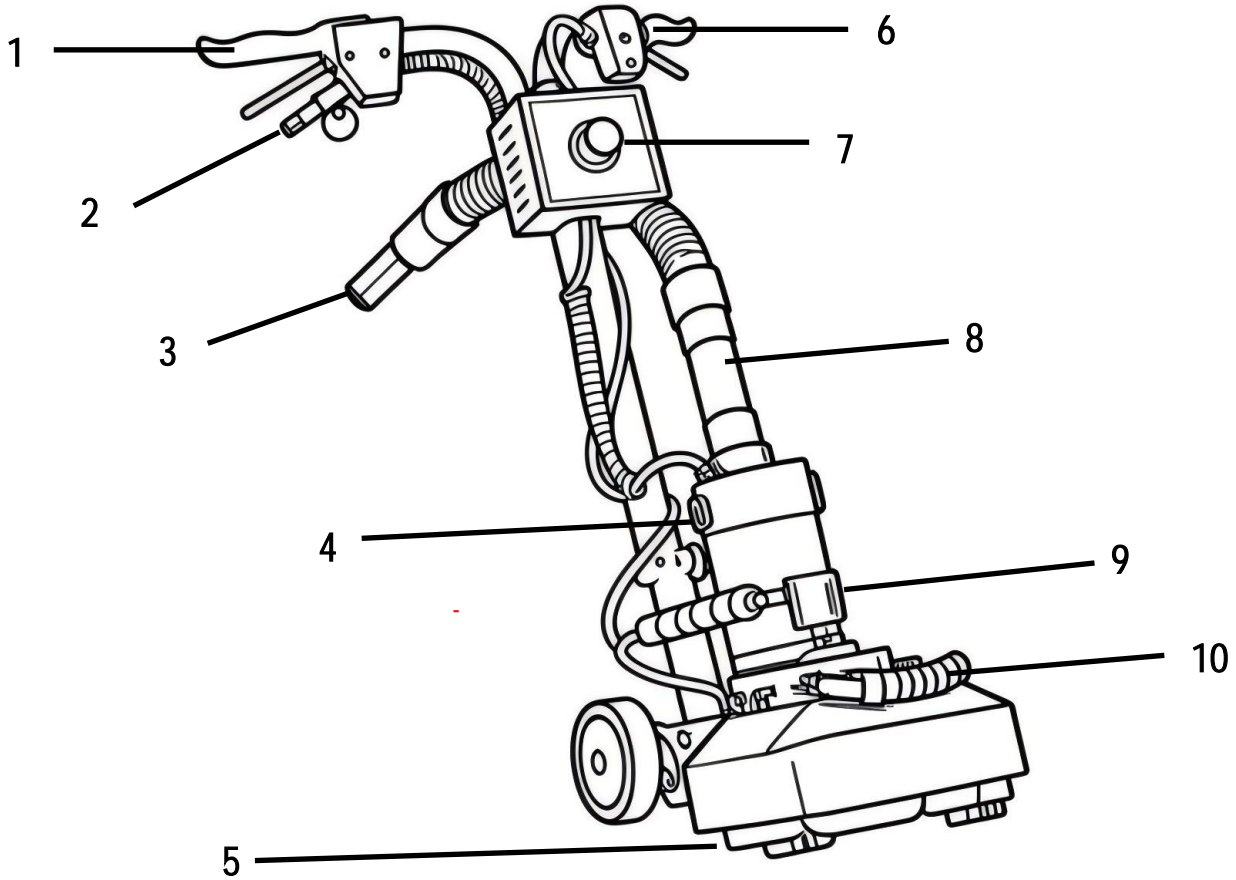

- 1. Handlebars
- 2. Solution hose quick disconnect fitting
- 3. Aluminum connector for vacuum hose
- 4. Motor
- 5. Cleaning head
- 6. Power switch lever
- 7. Motor speed control knob
- 8. View tube
- 9. Rotary union
- 10. Front lift handle

2 - Machine Operation

2.1 - Powering the FMJ-V15Pro

Plug the female end of the extension cord into the pigtail on the FMJ-V15Pro. Next plug the male end of the extension cord into a standard, grounded outlet. The plugs will light up when powered correctly.

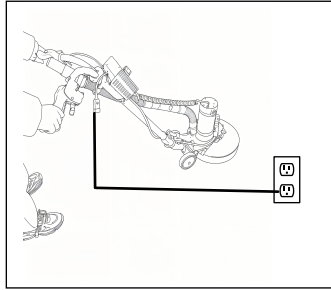

quick disconnect fitting coming from the handle. ♦

2.4 - Lowering the Handle

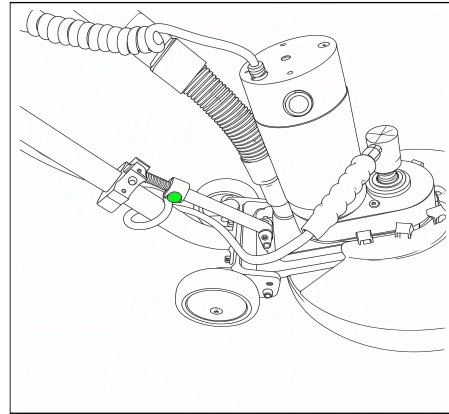

Lower the handle to a comfortable height by squeezing the adjustment knob on the front side of the handle and moving the handle down. Release the lever to lock the handle into place.

It is recommended the handle be set to about hip height when the head is flush with the ground for operation. ♦

2.5 - Switching on the FMJ-V15Pro

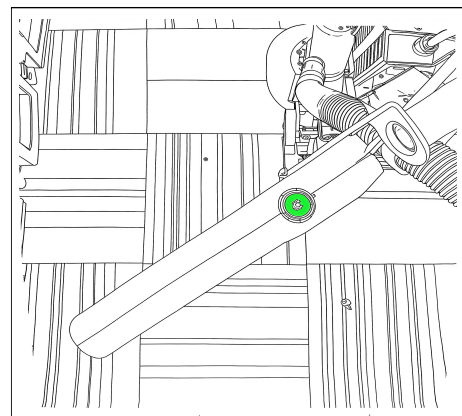

The handle is lifted until the cleaning head sits flat on the carpet and the wheels rise off the floor. With the machine positioned correctly, the power is turned on by pressing the button. After the machine powers up, the operator squeezes the handle lever to begin the cleaning process.

2.2 - Installing the Cleaning Head

Lay the FMJ-V15Pro back onto the handle. Take the cleaning head and place it into the FMJ-15 Pro housing, lining up the male threaded shaft on the head with the female threaded shaft on the FMJ-15Pro. Spin the head counter-clockwise until it stops.

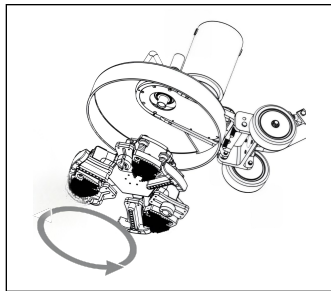

To remove the head, use the included head removal wrench and place it so it hooks onto the spray bars. Then, give it a sharp turn clockwise to break it loose. Spin the head off the rest of the way by hand. ♦

2.3 - Connecting the Steam Hoses

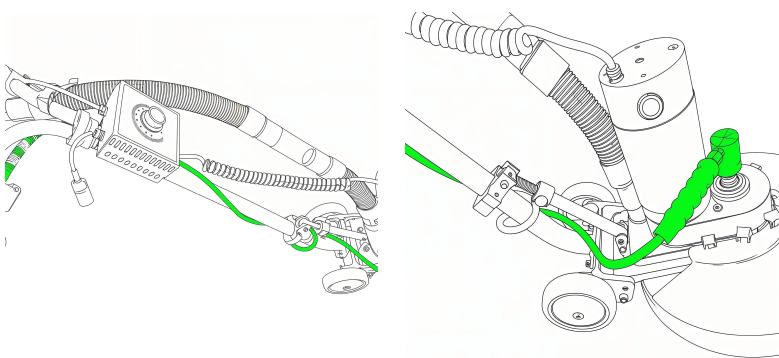

Connect a vacuum hose via 2" Cuff to the Aluminum connector for vacuum hose

Connect the female end of a solution line to the male

2 - Machine Operation

It may be easiest to set the motor speed to the lowest setting using the knob on the front of the handle before switching the machine on. ♦

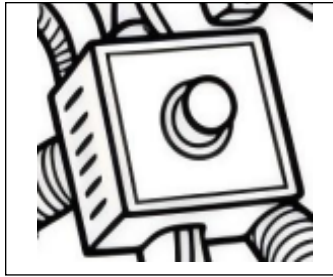

Remove any built up fibers or debris from the cleaning head and wipe down. Store the FMJ-15Pro in the included protective head cover to protect the cleaning head from damage. ♦

2.6 - Cleaning with the FMJ-V15Pro

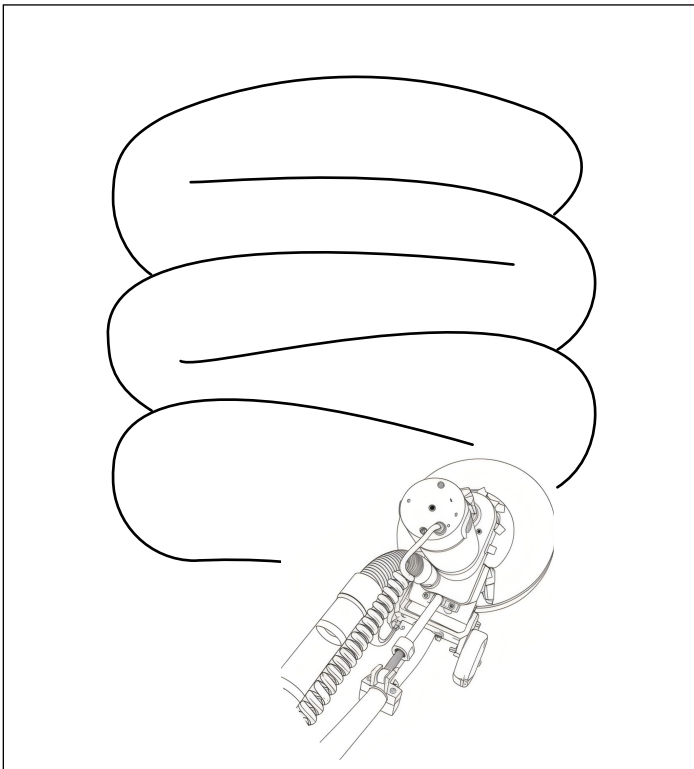

When operating, the FMJ-V15Pro will stay in one spot while spinning as long as the head is flush against the carpet. To swing the head to the right, lift the handle up slightly. To swing to the left, lower the handle slightly.

To spray solution, squeeze the solution lever on the right side of the handle.

For best results, clean using an arc pattern or a circular motion. ♦

2.7 - After Cleaning

After cleaning, switch off the FMJ-V15Pro by press the button.

3 - Machine Maintenance

In order to keep the FMJ-V15Pro running smoothly and reduce the risk of damage to the machine and subsequent downtime, FMJ-Group recommends following the maintenance schedule below:

Maintenance Item	Daily	Weekly
Inspect cords and hoses for breaks or tears. Replace any damaged items.	X	
Visually inspect machine for damage to cleaning heads, etc. Repair as necessary.	X	
Clean machine with an all purpose cleaner and damp cloth.	X	
Check the spray jets for even spray.	X	
Make sure felt vacuum seal is well lubricated.	X	
Wash the cleaning head and housing thoroughly, being sure not to wet the motor assembly. Clean any lint buildup from the star and vacuum heads.		X
Clean off any debris that is on the shaft of the motor or the hub of the cleaning head. If not cleaned regularly, debris here can damage the oil seal on the gearbox, and result in loss of oil. WARNING: Operating the unit without the gearbox properly lubricated can result in damage.		X
Coat the shaft with similar lubricant WARNING: When reinstalling the cleaning head, make sure that it spins freely. If it begins to require pressure, unscrew it and clean threads. Dirt or grit can block the threads, and if you continue to tighten, may lock the star on the motor shaft.		X

3.1 - Lubricating the Felt Vacuum Seal

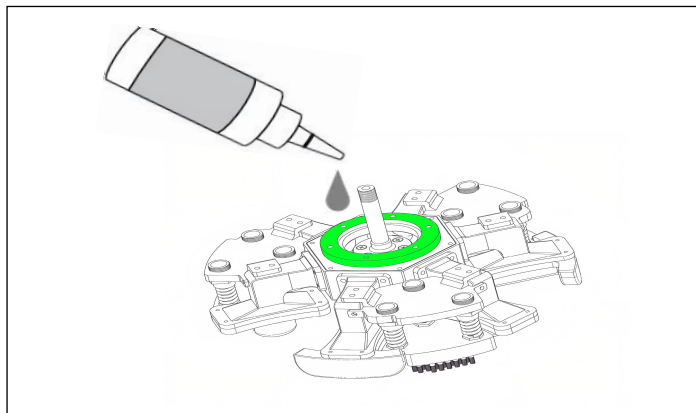

It is important to keep the felt vacuum seal lubricated thoroughly so as to reduce friction and ensure a tight vacuum seal. Use the included SuperLube® (part number PH648) to saturate the felt seal thoroughly as often as possible. ♦

3.2 - Oil Filling Port

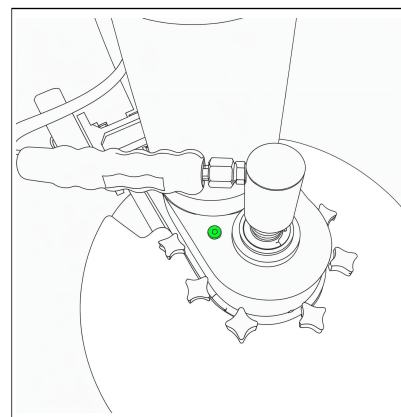

4 - Troubleshooting

Motor fan is spinning but cleaning head is not.	
Possible Cause	Solution
Pinion gear has broken.	Replace the pinion gear.

Machine power is powering the control board, but unit will not run.	
Possible Causes	Solutions
A power cord could be disconnected.	Check all cord connections, including the cord plug connections at the motor.
Activation button is faulty, or out of adjustment.	Replace activation button
Speed potentiometer is faulty.	Replace speed potentiometer.

Cleaning unit head seems to rotate slower than normal or motor is getting abnormally hot.	
Possible Cause	Solution
Felt vacuum seal ring is not properly lubricated.	Saturate felt vacuum seal with teflon oil or Sewing machine oil. Apply oil until near saturated, but not dripping.

Perceptible loss of vacuum.	
Possible Causes	Solutions
Check that the felt vacuum seal in head is not worn, crushed, or dry.	Replace felt vacuum seal Lubricate new seal before installation.

Motor smokes, sparks, cycles power, or has a substantial decrease in power.	
Possible Causes	Solutions
Motor carbon brushes are likely worn.	Replace motor carbon brushes immediately

NOTES